

# Integral Bus Mounting Bracket

For use with Integral Bus

Mounts integral bus to most surfaces. #8 flat head screws recommended. Blocking or engineered anchors required.

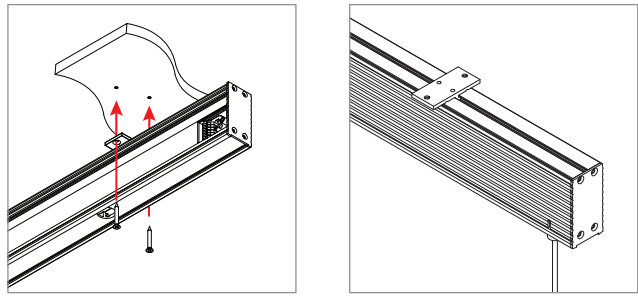

Technical Support: 707-996-9898

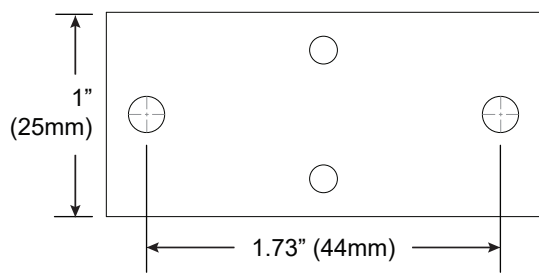
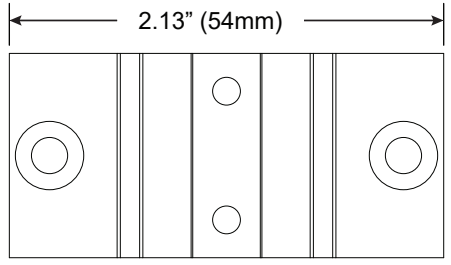
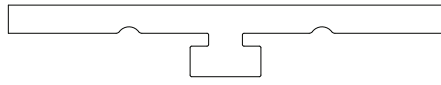
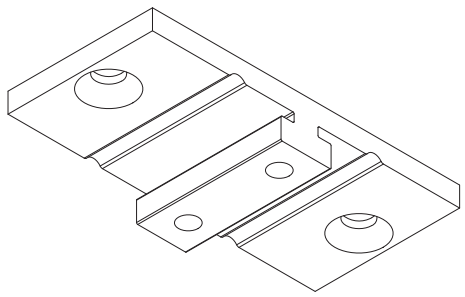

PART NUMBER **BK-167-C-YY**

DESCRIPTION Bracket, integral bus, ceiling mount, clear anodized, black anodized or white painted finish.